

2S2/0-HEX-M IS FITTED WITH 11703-M SCREW SOCKET SIZE .197" 5mm ACROSS FLATS

WIRE SIZE RANGE		RATED TORQUE	
mm2	AWG	In-pounds	N-M
67,4 - 26	2/0-3	50	5,6
21,2 - 13,2	4 - 6	45	5,1
8,4	8	40	4,5
5,3 - 2,1	10 - 14	35	4,0

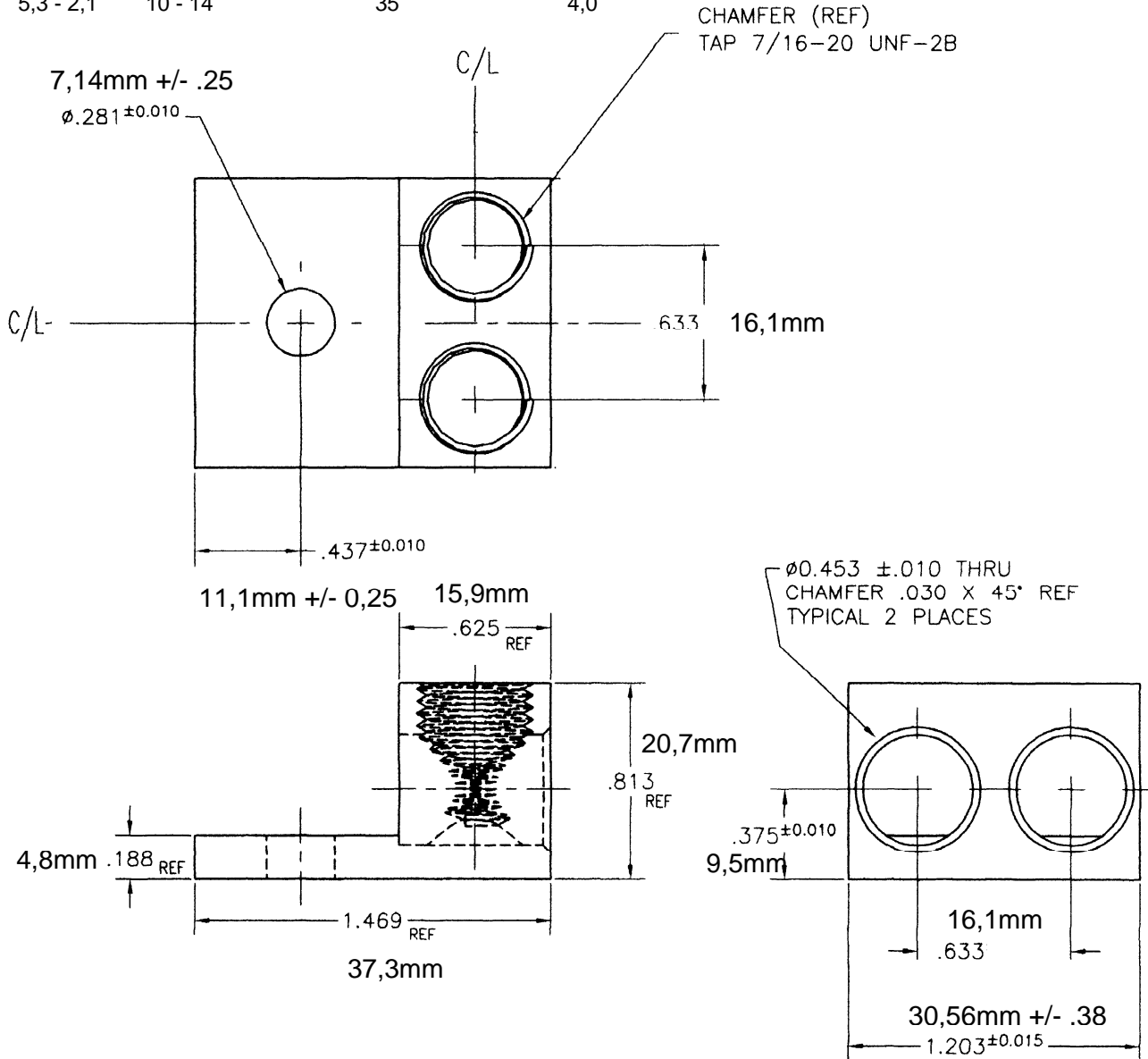

USE SCREW 11703-M
UL REF 14126/14140 with
socket option .197" A/F 5mm

MARKING: DIE # 14255

IHI, 2S2/0, 2/0-14

CU9AL



THIS DRAWING AND DESIGN ARE THE PROPERTY
OF INTERNATIONAL HYDRAULICS INC.,
CLEVELAND, OHIO, AND MAY NOT BE
DUPLICATED, USED FOR BASIS OF DESIGN OR
MANUFACTURE WITHOUT THE WRITTEN
PERMISSION OF INTERNATIONAL HYDRAULICS
INC., CLEVELAND, OHIO.

MATERIAL
EXTRUSION #1075 (6061-T6)
FINISH
TIN PLATED
EMS 131A

INTERNATIONAL HYDRAULICS, INC.

TITLE
DOUBLE LUG - ALUMINUM
WIRE RANGE 2/0 - 14
5mm ACROSS FLATS HEX WRENCH KEY

SIZE	DRAWN BY	CHECK	DWG NO	REV
A	JDB		2S2/0-HEX-M	
DATE 01.10.2000			THIS IS A CAD DRAWING, DO NOT MANUALLY REVERSE	